

Restaurant premises management system

Capable of connecting headquarter and branch premises via live video and voice

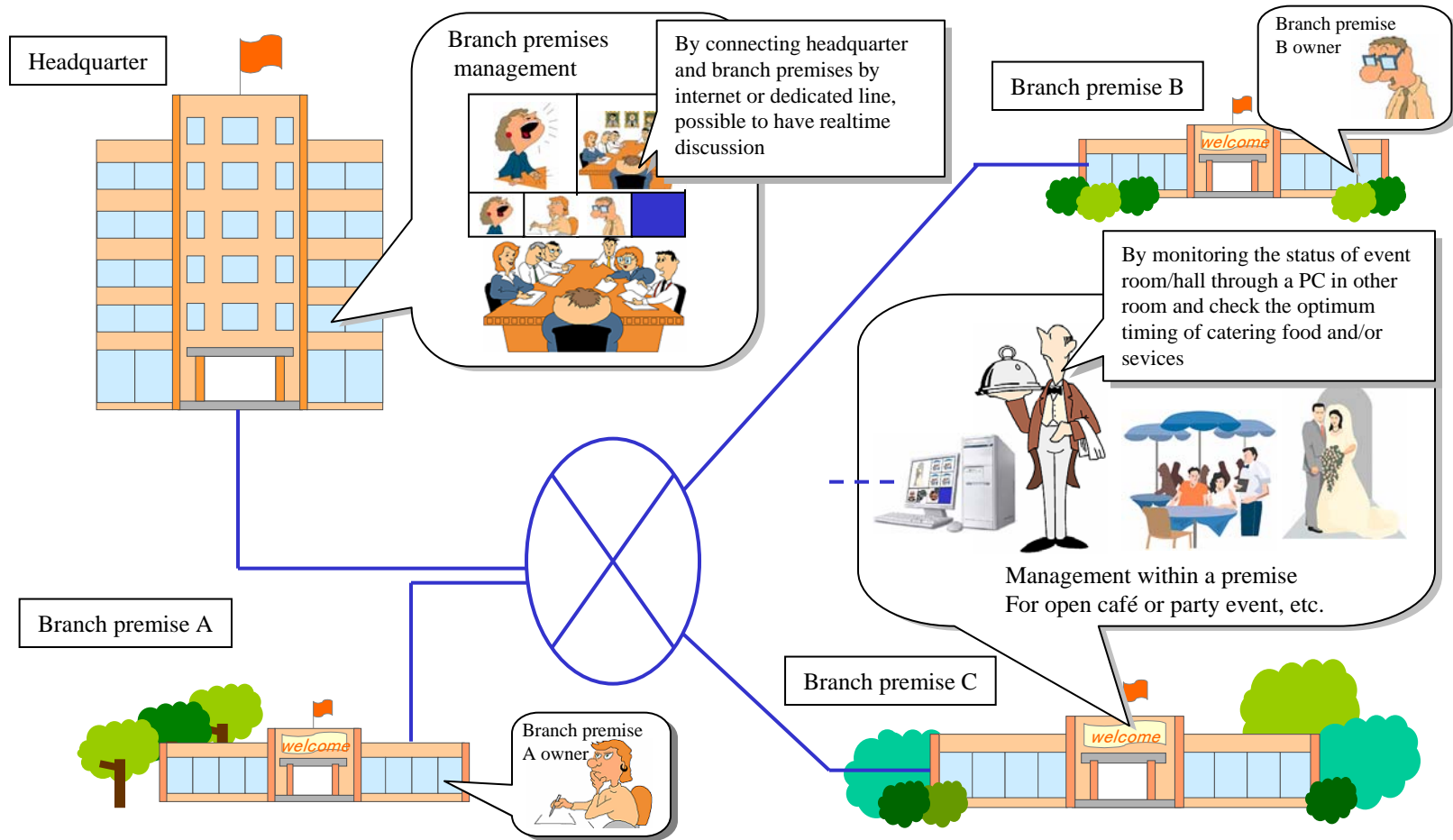

[Remarks]

The application examples published herein, are intended as hints for users for studying potential applications.

Neither guaranteeing the performance nor granting license. Copying or modifying whole or part of the articles shown herein without our prior approval is prohibited by copyright.

- * Possible to monitor videos through cameras installed in each premise, with a central PC.
- * Capable of bi-directional video/voice communication by connecting 2 LsBoxes". More accurate/precise understanding is possible by realtime video. TV conference between H.Q and branch premises is possible through internet or dedicated line.
- * KAM, our own video format, is very small in file size compared with MPEG, and reduces stresses during file transfer. Requires dedicated playback software, but can be used for security enhancement, effectively.
- * Capable of locking/unlocking the electronic lock, turning lighting/advertisement, alarm switches on PC screen.

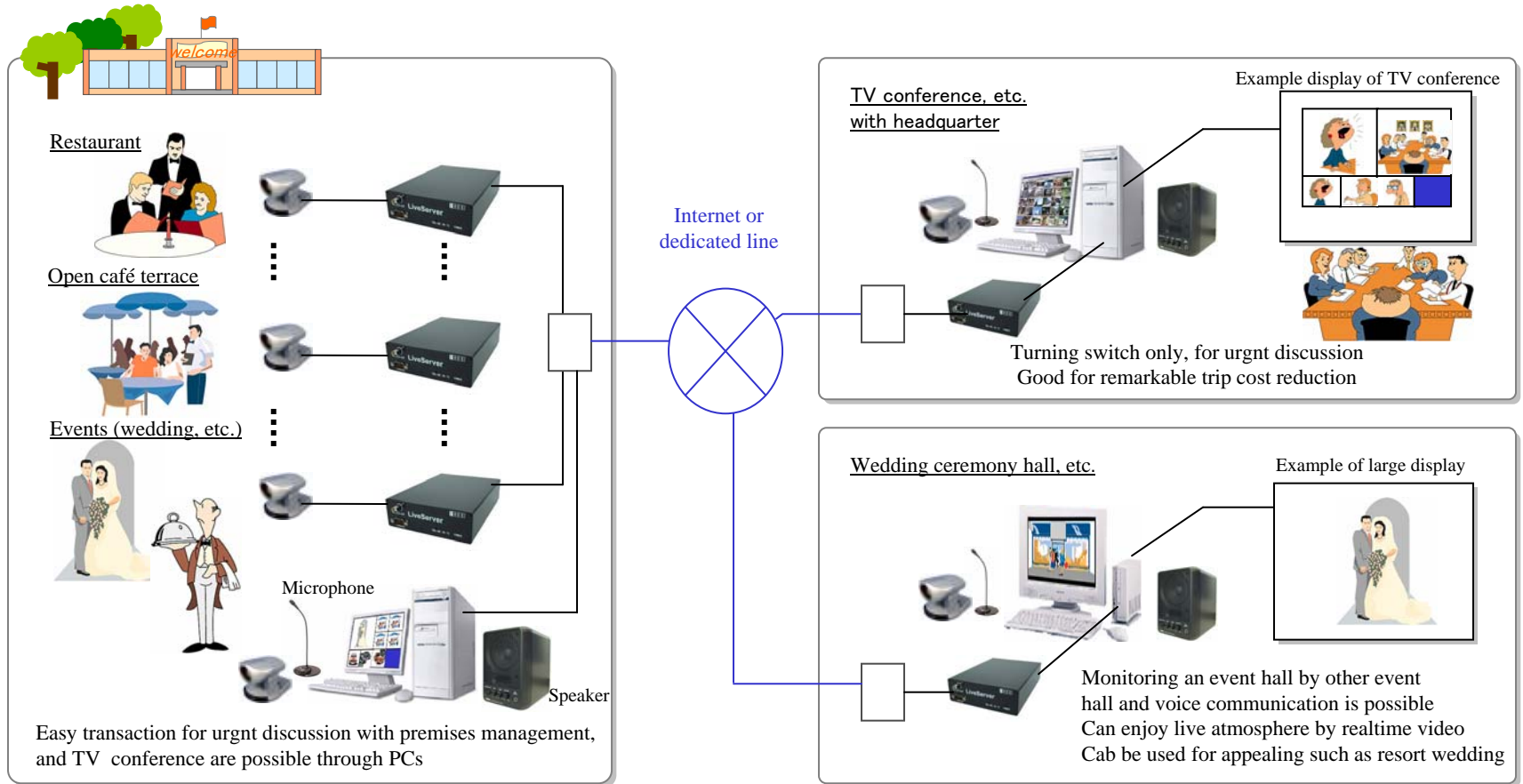

This is a basic system, and possible to customize according to requirements like building configuration, facility scale, etc.